



## **Beijing Normal University Study Tour**

**3<sup>rd</sup> – 14<sup>th</sup> February 2020**

Griffith Law School  
Griffith University, Australia

Prepared for: **Beijing Normal University**

## Contents

INTRODUCTION.....	3
Griffith University.....	3
International Business Development Unit (IBDU) .....	3
Griffith Law Schools .....	4
PROGRAM CONTENT .....	5
Proposed Program Schedule .....	5
Program Schedule .....	5
Workshop Leader.....	7
Associate Professor Therese Wilson, Dean of Law and Head of Griffith Law School.....	7
QUOTATION.....	8
Program Cost.....	8
<b>Accommodation Quotes.....</b>	<b>9</b>
<b>Brisbane Accommodations (2<sup>nd</sup> – 15<sup>th</sup> Feb).....</b>	<b>9</b>
<b>STUDENT ONE Brisbane City – 4-6 student apartments for 14 nights.....</b>	<b>9</b>
Services .....	10

## INTRODUCTION

### Griffith University

#### At Griffith, we believe in, strive for and celebrate the Remarkable

*The remarkable people who better our world, the remarkable experiences that transform people and communities, and the remarkable contributions that change the future forever.*

We know success often comes from being an exception to the norm—challenging convention, adapting and innovating, creating bold new trends and pioneering solutions ahead of their time. At Griffith, remarkable is the norm.



Since we started teaching over 40 years ago, we have been deeply connected to the Asian region, socially conscious and environmentally aware, an integral part of the community and heavily industry focused. We have also become a comprehensive, research-intensive university, ranking in the top 2% of universities worldwide.

Griffith was one of the first universities in Australia to develop degrees in Tourism and Hotel Management and we continue to lead the field today. In the 2018 QS World University Subject Rankings, our Hospitality and Leisure Management subjects ranked number one in Australia and eleventh globally. In further success, in the most recent Academic Ranking of World Universities, Shanghai Jao Tong Rankings Hospitality and Tourism Management ranked second globally.

Our teaching and research spans six campuses in South East Queensland and all disciplines, while our network of more than 200,000 graduates extends around the world.

*We believe in the potential for all people to become remarkable. Remarkable is earned.*

It is home to approximately 50,000 students studying one of 200+ degree programs. At Griffith, We believe in a remarkable tomorrow, in doing our best and supporting others to do theirs. Our founders knew professional and industrial environments constantly vary and that universities needed to equip their students with the skills to adapt and lead positive change for the future.

We've never lost sight of our progressive beginnings and everything we do—from education to research and community engagement—is designed to not only meet, but improve the new world our students, graduates and communities will encounter.

With a focus on industry connections and hands-on experience, Griffith University's global perspective is preparing graduates for tomorrow's international job market. Griffith's teaching excellence has been consistently recognised by prestigious Australian Learning and Teaching Council Grants awarded to academic staff for Teaching Excellence.

### International Business Development Unit (IBDU)

Administrative, logistical, financial and HR management will be coordinated by IBDU, which has over 27 years of experience working across diverse cultures on development projects, and will be supported by Griffith University's central administrative departments. Griffith's Office of Finance will be responsible for invoicing and payment requirements.

IBDU will provide efficient administrative support including contracting team members; briefing and debriefing specialist presenters; and managing accommodation and transport logistics.

All matters relating to the proposed program for 2020 please contact:

Ms Helen Bulle  
Manager, International Business Development Unit (IBDU)  
Griffith International  
170 Kessels Road  
Nathan, Qld 4111 Australia  
T: +61 7 3735 7091  
E: [h.bulle@griffith.edu.au](mailto:h.bulle@griffith.edu.au)

Established in 1992, the International Business Development Unit specialises in the management of international development assistance projects for donor agencies such as the Australia Government Department of Foreign Affairs and Trade, ADB and World Bank, and the development of focused training programs for foreign governments and business corporations. IBDU has over a 27-year record of delivering a wide variety of flexible, distance, online and traditional based education projects on budget and on time, made possible by an adherence to standard project management methodologies.

## **Griffith Law Schools**

For 26 years, Griffith Law School has been preparing the legal experts of tomorrow to tackle the unique challenges of our contemporary, globalised society. Our students don't just understand the law but have the knowledge and skills to change it.

In 2017, the discipline of law at Griffith University was ranked 38th in the world, 3rd in Australia and 1<sup>st</sup> in Queensland (2017 Academic Ranking of World Universities).

The School is committed to social justice and offers a curriculum that is practical, critical and global in outlook. We offer an interdisciplinary legal education with a diverse range of double degrees, and students gain extensive practical skills through mooting, negotiation, research and other skills-based learning opportunities.

The Griffith Legal Clinic program enables students to engage in legal practice, policy work and community legal education, working with real clients and cases with our clinic partners.

Students have many opportunities to gain an international perspective on the law through exchanges with partner institutions abroad, a wide range of international law courses, and international competitions. Griffith Law School is home to internationally renowned scholars who are at the forefront of legal research and reform. Our legal research has been consistently recognised by the Australian Research Council as 'above world standard'.

---

## PROGRAM CONTENT

### Proposed Program Schedule

<b>Arrive Brisbane:</b>	Sunday 2 February 2020
<b>Sustainable Business Management Program:</b>	Monday 3 – Friday 14 February 2020
<b>Depart Brisbane:</b>	Saturday 15 February 2020

The program will take place over a 2-week period between 3 to 14 February 2020 at Griffith University's Nathan and Gold Coast Campus.

The course content will be delivered through classroom lectures, seminars, guest speakers and group learning activities along with site visits.

### Program Schedule

The training will include sessions as outlined in the schedule below and include visits to Law Courts and meetings with local lawyers. The program will also include some social and cultural activities.

*\* This proposed program schedule is subject to change.*

Day	Time	Session
<b>Sunday 2 February</b>		Arrive in Brisbane Airport ( <b>TBC</b> ) Meet Griffith University representative Coach transfer to Accommodation Arrival Briefing
	9:00-10:30am 11:00-11:30am	Public transport to Nathan Campus Campus Tour and Computer Access <b>Official Welcome</b> <i>AProf Therese Wilson, Dean of Law and Head of School</i> <i>AProf Kylie Burns, Deputy Head of School</i>
<b>Monday 3 February</b>	12:00pm	<b>Welcome Lunch</b>
	1:00–3:30pm	<b>Wildlife Show and experience for International Students @ the Griffith University Eco-Centre</b>  Public transport back to accommodation.
<b>Tuesday 4 February</b>	9:00-12.00pm	<b>WORKSHOP: Introduction to the Australian Legal System</b> Dr Steven White
	12:00-1.00pm	<b>Lunch break</b>  <b>Free afternoon</b>
<b>Wednesday 5 February</b>	9.00am	Coach Transfer
	9:30-10:30am	<b>SITE VISIT: Tour of Supreme Court</b>
	10:30-11.30am	<b>Talk with Justice Mullins</b>
	11:30-12:30pm	<b>Tour of Supreme Court Library</b>

	12:30-1:30pm	<b>Lunch break</b>
	1:30pm	<b>End of day - Return to accommodation (via public transport)</b>
<b>Thursday 6 February</b>	9:00-12.00pm	<b>WORKSHOP: Introduction to International Law and Legal Systems</b> AProf Susan Harris-Rimmer
	12:00-1.00pm	<b>Lunch break</b> <b>Free Afternoon</b>
<b>Friday 7 February</b>	9:00-12.00pm	<b>WORKSHOP: Criminal Procedure and Sentencing</b> Mr Shahram Dana
	12:00-1.00pm	<b>Lunch break</b> <b>Free Afternoon</b>
<b>Saturday 8 February</b>	9:00am 10:00am 2:30pm	<b>Coach Transfer</b> Koala Sanctuary <b>End of day - Return to Brisbane (coach transfer)</b>
<b>Sunday 9 February</b>	Free day	
<b>Monday 10 February</b>	8:15am	<b>Coach Transfer</b>
	9:30am	<b>Cultural visit and experience:</b> <i>Jellurgal Aboriginal Cultural Centre International Student experience</i>
	1:30pm	<b>End of day - Return to Brisbane (coach transfer)</b>
<b>Tuesday 11 February</b>	9:00-12.00pm	<b>WORKSHOP: International Dispute Resolution</b> AProf Therese Wilson, Dean of Law and Head of School
	12:00-1.00pm	<b>Lunch break</b>
	1:00 – 2:00pm	<b>Gold Coast Campus tour</b>
<b>Wednesday 12 February</b>	9:00-12.00pm	<b>WORKSHOP: Intellectual Property</b> Professor Charles Lawson
	12:00-1.00pm	<b>Free Afternoon</b>
<b>Thursday 13 February</b>	9:00-12.00pm	<b>WORKSHOP: Wrongful Conviction and the Innocence Project</b> Dr Robyn Blewer
	12:00-1.00pm	<b>Free afternoon</b>
<b>Friday 14 February</b>	8:15 am	<b>Coach Transfer</b>
	9:30-11:30am	<b>SITE VISIT: Southport District Court</b>
	11:30-12:00pm	Bus pickup - Gold Coast campus
	12:00-12:30pm	<b>Program Review and Evaluation (IBDU)</b>
	12:30-1:00pm	<b>Certificate Presentation and Farewell</b>
	1:00pm	<b>Farewell Lunch</b>

<b>Saturday 15 February</b>	2:30pm	<i>End of day - Return to Brisbane (coach transfer)</i>
	Coach Transfer to Brisbane Airport Arrive Brisbane International Airport and Check in for Flight ( <i>Flight TBC</i> ) Depart	

## Workshop Leader

**Associate Professor Therese Wilson, Dean of Law and Head of Griffith Law School**



Associate Professor Wilson is admitted as a solicitor of the Supreme Court of Queensland. Her areas of research include international commercial law, international commercial arbitration, and consumer law. Her areas of teaching expertise include corporate law, banking and finance law and international commercial arbitration.

A/Prof Wilson completed her PhD thesis in 2010 on “Regulating to Facilitate Access to Safe and Affordable Credit for Low Income Australians,” and has served as chair of the Australian Financial Inclusion Network and as chair of the board of a community development finance institution, Foresters Community Finance Limited.

A/Prof Wilson has coached Griffith Law School’s Vis International Commercial Arbitration Moot team since 2003 and has published two books with Ashgate, ‘Codifying Contract Law’ and ‘International Responses to Issues of Credit and Over-indebtedness in the Wake of Crisis’.

## QUOTATION

### Program Cost

The per participant cost is based on a two-week customised training program including program coordination, management and evaluation, tuition, site visits, cultural activities, student accommodation and airport transfers is as follows:

Program costs are dependent on a group of a **maximum of 20 participants** in 2020 based at Griffith University's Brisbane and Gold Coast campus.

#### Program ONLY Fees (Table. 1)

Item – Program costs	20 Students
Per Participant	AUD \$ 2,580
<b>Total Program Cost</b>	<b>AUD \$ 51,600</b>

Table.1 Cost includes:	Table.1 Cost does NOT include:
<ul style="list-style-type: none"> <li>• Program delivery as outlined in schedule</li> <li>• Program development fee</li> <li>• Administration fees</li> <li>• Venue hire and Internet</li> <li>• Accompanying staff with all industry visits and off campus activities.</li> <li>• Airport transfers on arrival and departure - <i>*Brisbane Airport and must arrive as a group</i></li> <li>• Go cards – unlimited travel within South East QLD</li> <li>• Site visits and transfer costs as per the schedule</li> <li>• Welcome lunch</li> <li>• Farewell lunch</li> <li>• Graduation ceremony</li> <li>• Certificate of program completion</li> <li>• Excursions as outlined in the schedule</li> </ul>	<ul style="list-style-type: none"> <li>• International flights</li> <li>• Visa fees and requirements</li> <li>• Travel or medical or accident insurance</li> <li>• Interpretation and Translations services</li> <li>• Individual Airport transfers <i>*if participants arrive on different flights</i></li> <li>• Daily allowance</li> <li>• Daily meals</li> <li>• Accommodation <i>*for accommodation cost , please see accompanying quote</i></li> <li>• Accommodation for accompanying staff members</li> </ul>
<p><b>Fee Payment</b>            Upon confirmation of the program, you will be sent a <b>contract for signing and an invoice</b> for payment. Instructions will be outlined on the invoice of how the invoice can be paid. Full payment of all program fees must be received 4 weeks before program commencement.</p>	



## Accommodation Quotes

### Brisbane Accommodations (2<sup>nd</sup> – 15<sup>th</sup> Feb)

#### STUDENT ONE Brisbane City – 4-6 student apartments for 14 nights

Item – Program costs	Cost (20 students)
Per Participant	AUD \$ 1,130
<b>Total Program Cost</b>	<b>AUD \$ 22,600</b>

#### This cost ONLY includes:

- Shared 4/5/6 bedroom for 14 nights.
- Individual furnished rooms
- Features
  - 2/3 common toilets/showers per apartment to share.
  - Free unlimited internet
  - 24/7 On-site staff support
  - All Kitchen Essentials
- Air-conditioning
- Water
- Electricity
- Fully furnished
- FREE Bike Hire
- Access to swimming pool, gym, cinema, games room, study floors, fully kitted out rooms
- 24 hours reception
- FREE \$10 pre-paid Vodafone SIM card \*subject to availability

*\*Costs subject to change and availability*

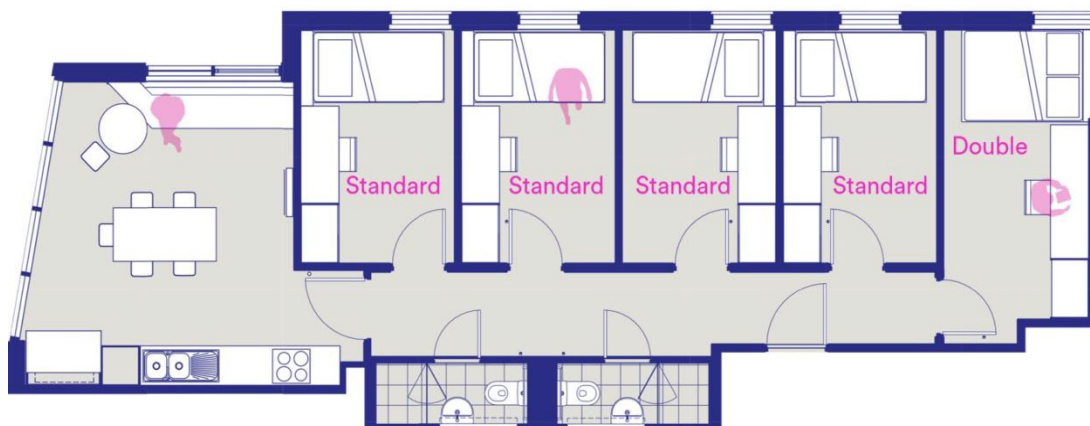
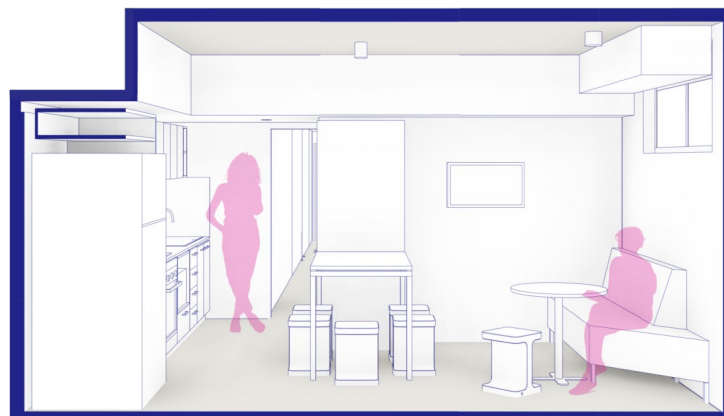

## Services

### Accommodation

Depending on the accommodation quotes and option selected, IBDU will source and arrange the accommodation for the participants.

### International & Domestic Flights

This proposal does not include the costs of these fares.

### Health, Travel and Accident Insurance

The nearest Australian Embassy should be contacted to identify the relevant visa required for this program and the processing time involved. Participants are advised to lodge their visa applications as early as possible to allow adequate processing time.

The cost of the program does not include health, accident or travel insurance. It is a program requirement that this be organised before departure to Australia. It is requested that information regarding the participants' health, accident and travel insurance are provided to IBDU six weeks prior to the program start. Details required for each student include:

- name, address and contact details of the insurance company
- details of an Australian branch or their Australian representative if they have one
- policy number
- the monetary value of cover for medical expenses

### Airport Transfers

The group will be met on arrival at the Brisbane International or Domestic Airport by a representative of Griffith University and accompanied by bus to the accommodation. On completion of the program, a group transfer will be arranged from the accommodation to the airport. This service is included in the total program cost and can only be provided when the group arrives and departs together on the same flight. Individual transfers will be the participant's responsibility to arrange.

### Daily Transfers

Daily public transport and travel costs are included in the program costs for individual participants. Go Card with unlimited travel for travel on the Brisbane and Gold Coast City public transport network.

### Campus Facilities, Computers and Student Support Services

Griffith University provides a range of student support services as part of the program such as free access to internet facilities and use of campus library facilities and services. Griffith University has 5 campuses equipped with the latest audio-visual equipment, technologies and modern classrooms.

### Smoke-free campuses

For the health, comfort and wellbeing of all our students, staff and visitors, Griffith University is a smoke-free campus. At Griffith University, we are committed to providing staff, students and visitors with a productive, vibrant, safe and healthy working and learning environment.

---

## Terms of Quotation:

1. *The price quoted is for the number of participants as shown above and for the itinerary, which has been provided. Any change from these numbers, or from the provided itinerary may result in a change to the price per participant.*
2. *One payment of 100% of the total program cost (including any extra options: accommodation, meals, etc) will be made on invoice after the contract is signed and four weeks prior to workshop delivery. Instructions will be outlined on the invoice of how the invoice can be paid.*
3. *The consolidated participation listing, passport scans and insurance details should be sent via email at least six weeks before the program commencement.*
4. *Advice of arrival and departure flights should be provided at least six weeks prior to the commencement of the program.*

5. *Students or participants over the age of 15 years will be accepted into this program.*
6. *Quote valid until 30 December 2019.*

### **Refund and Cancellation Policy**

- *Full fees must be received at least four-weeks before course commencement date*
  - *Cancellations received more than four-weeks before course commencement will normally receive a full refund of tuition fees and homestay accommodation fees*
  - *Cancellations received less than four- weeks before course commencement will normally receive a refund of tuition fees and homestay accommodation fees less a cancellation administration charge of one week's tuition fee per participant*
  - *Cancellations received after course commencement will not be eligible for a refund*
-